



24 Pine Valley Mews
Dinnington





24 Pine Valley Mews, Dinnington, Newcastle Upon Tyne, Tyne And Wear, NE13 7FL

Offers Over £395,000

Beautifully presented, five bedroom detached home, occupying a fabulous position overlooking green land to the entrance of this recently constructed development within the popular village of Dinnington. This beautifully proportioned property was constructed in 2018 by Persimmon Homes, and has been finished and upgraded to a lovely standard, whilst enjoying the benefit of town garden, with parking to front giving access to a large detached garage and generous enclosed lawned rear garden.

Entrance hallway with ground floor WC | Spacious lounge to the front elevation | Second generous reception room which may be utilised as a formal dining room or family snug | Fabulous kitchen /dining room room, extending across the rear elevation. The kitchen is fitted in a modern shaker style, with quality Neff integrated appliances including induction hob with extractor, double oven, fridge/freezer and dishwasher. From the dining area there a French doors leading out to the rear gardens | Utility room with integrated washer/dryer and side access door | To the first floor | Master bedroom with views from the front over open green land. Mirrored built in wardrobe and ensuite shower room/wc | Two further double bedrooms one with built in mirrored wardrobe | Two good sized single bedrooms, one with mirror fronted built in wardrobe | Family Bathroom/wc | Externally - There is a small town garden to front with surfaced parking to the side elevation leading to a large detached garage. An access gate leads to a generous enclosed lawned garden with patio.

Services: Mains Electric, Gas, Water & Drainage | Tenure: Freehold | Council Tax: Band E | EPC: B







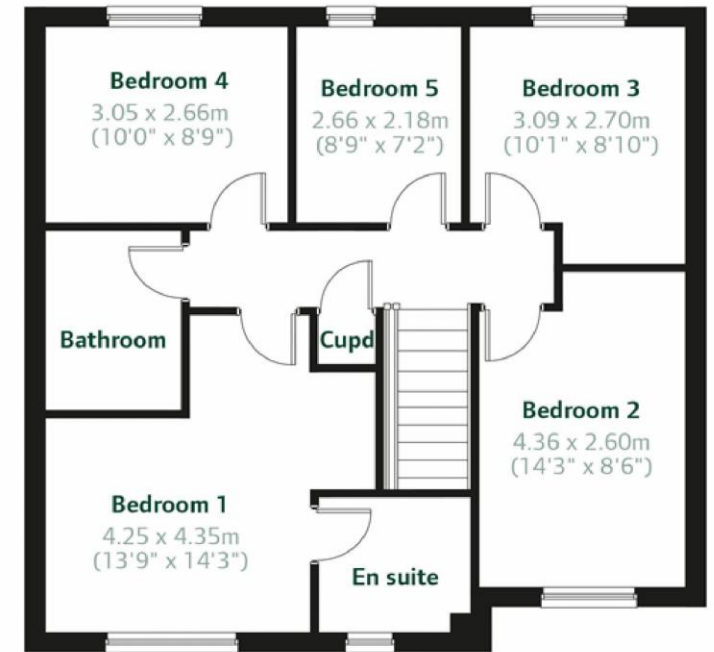
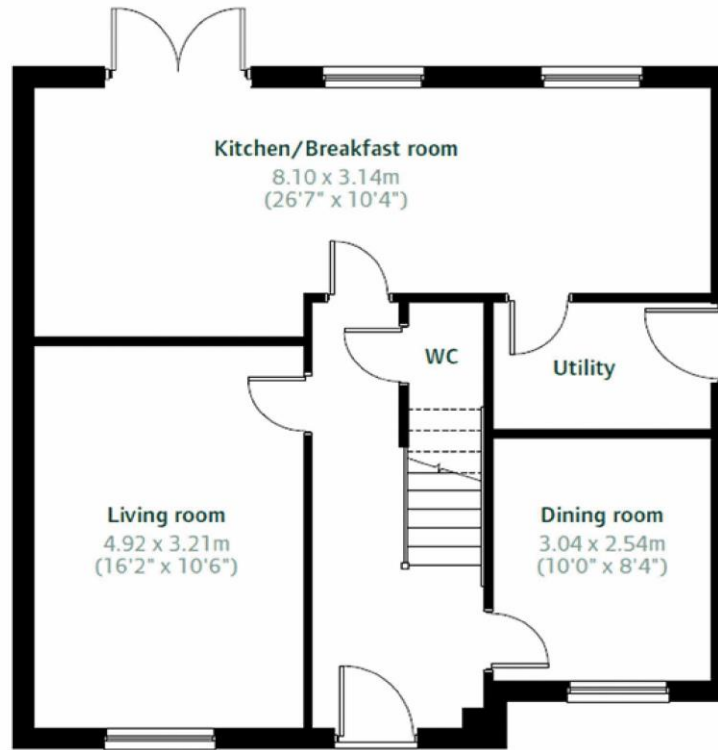

First floor

All enquiries to our Ponteland Office | Coates Institute, Main Street, Ponteland, Newcastle upon Tyne NE20 9NH

T: 01661 823951 | www.sandersonyoung.co.uk

