



20 Fairney Edge
Ponteland





20 Fairney Edge, Ponteland, Newcastle upon Tyne NE20 9EF

Guide Price £260,000

TWO BEDROOM SEMI DETACHED BUNGALOW, LOCATED TOWARDS THE EASTERN EDGE OF PONTLEAND VILLAGE WITH OPEN RURAL ASPECT VIEWS TO THE OPEN FIELDS, GARDENS AND GARAGE.

A well-presented and updated two-bedroom semi-detached bungalow, with a lovely rear garden with an open aspect views to the fields and surrounding countryside, driveway for two cars and attached single garage. The property, located in a quiet cul de sac in the centre of the village, has been upgraded with a modern fitted kitchen (within the last 4 years) and a shower room with wc and basin in a vanity unit (within the last 18 months). The bungalow benefits from uPVC double glazing, gas central heating and an electric garage roller door.

Hallway with built in cupboard | Sitting/dining room with fireplace and patio doors opening to the rear garden | Fitted kitchen with integrated electric hob and double oven, and space for a fridge and dishwasher | Double bedroom with fitted wardrobes and drawers to one wall | Second bedroom with double door built in wardrobe with drawers under | Shower room/wc | Single garage with roller door, plumbing for a washing machine, space for a tumble drier and gas boiler to the wall | Door from garage to the rear garden | Driveway with parking for two cars | Attractive rear garden with lovely open views, patio terrace and timber summer house | NO UPWARD CHAIN

Services: Mains electric, gas, water and drainage | Tenure: Freehold | Council Tax: Band D | Energy Performance Certificate: Rating D





Ground Floor

Approx. 77.1 sq. metres (830.4 sq. feet)

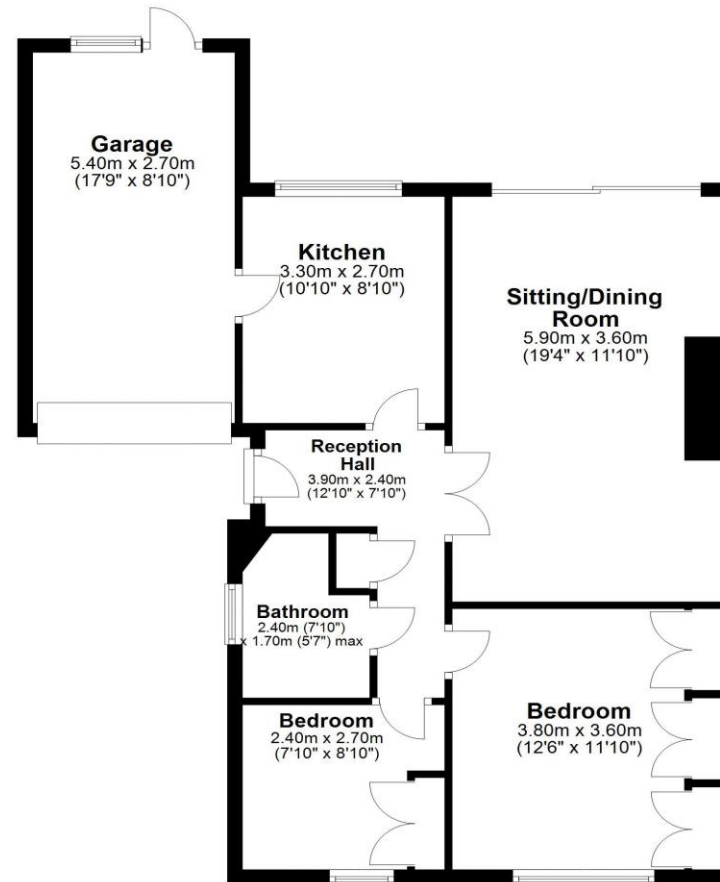

Total area: approx. 77.1 sq. metres (830.4 sq. feet)
20 Fairney Edge, Ponteland

All enquiries to our Ponteland Office | Coates Institute, Main Street, Ponteland, Newcastle upon Tyne NE20 9NH

T: 01661 823951 | www.sandersonyoung.co.uk

