



Roseneath, 3 Guilden Road
Warkworth





Roseneath, 3, Guilden Road, Warkworth, Morpeth, Northumberland, NE65 0TJ

£210,000

Well proportioned, three-bedroom detached bungalow set within a generous, mature garden site on Guilden Road, just a short distance from the heart of the sought-after village of Warkworth. The property currently offers gas central heating to radiators with timber framed double glazing although would now require refurbishment and modernisation.

Entrance porch | Spacious hallway with parquet flooring | Lounge with brick feature fireplace | Fitted kitchen | Utility | Three double bedrooms | Family Bathroom/wc | Externally - Large gravelled driveway for ample off-road parking with large mature garden.

Services: Mains Electric, Gas, Water & Drainage | Gas Central Heating | Tenure: Freehold | Council Tax: Band D | EPC: D





Ground Floor

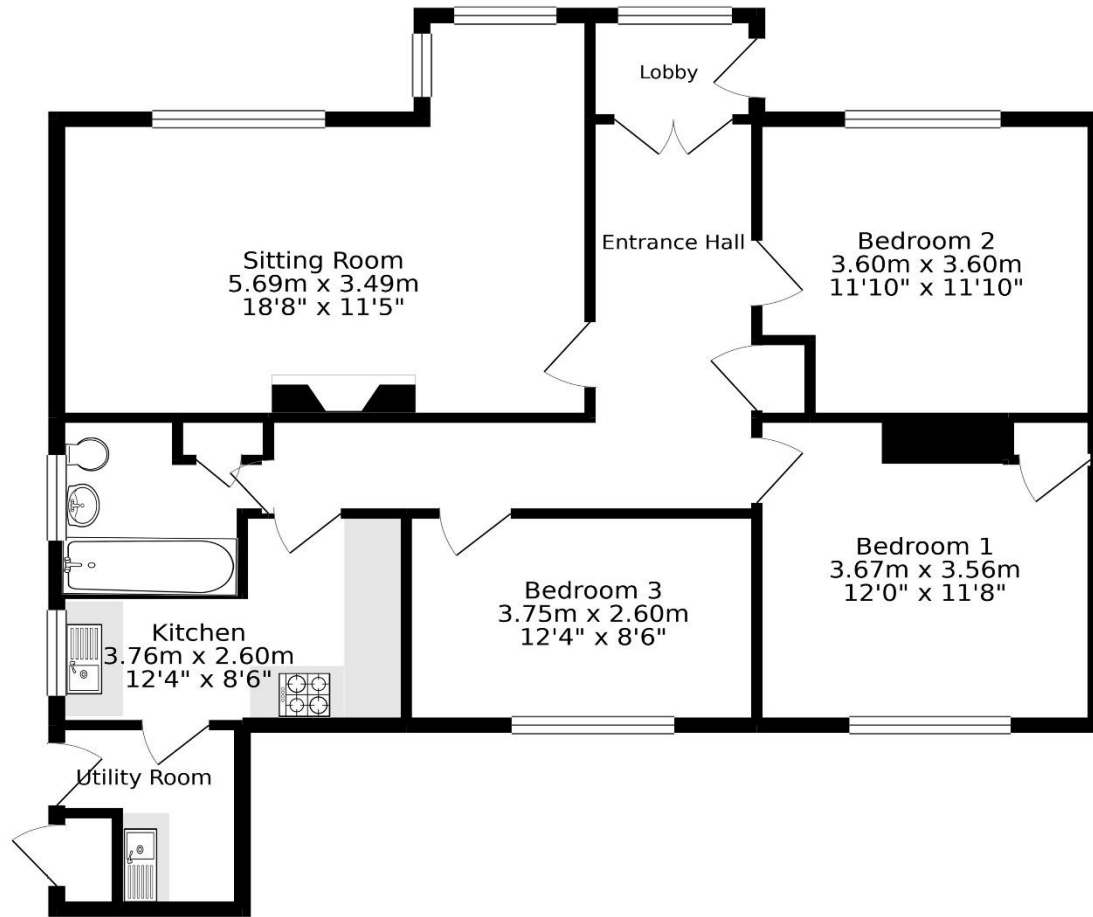

Whilst every attempt has been made to ensure the accuracy of the floorplan contained here, measurements of doors, windows, rooms and any other items are approximate and no responsibility is taken for any error, omission or mis-statement. This plan is for illustrative purposes only and should be used as such by any prospective purchaser. The services, systems and appliances shown have not been tested and no guarantee as to their operability or efficiency can be given.
Made with Metrage ©2019

All enquiries to our Alnwick Office | 35 Bondgate Without, Alnwick, Northumberland NE66 1PR

T: 01665 600 170 | www.sandersonyoung.co.uk

