



33 Briardene Crescent
Gosforth





33 Briardene Crescent, Gosforth, Newcastle upon Tyne NE3 4RX

Guide Price £335,000

Well presented 5 bedroom semi detached home, occupying a generous and mature private garden site on this popular residential road. The property has been extended to the first floor to add two good sized bedrooms and a shower room/wc, creating a well proportioned family home which benefits from gas central heating to radiators and double glazing with off street parking and single attached garage.

Glazed Entrance porch with tiled floor. | Reception Hallway which has stairs to the first floor. | Dual aspect lounge/ dining room with large bay window and feature fireplace with gas living flame fire to the lounge area and sliding patio doors from the rear onto the garden. Fitted kitchen breakfast room which includes stainless steel range style cooker with extractor. | From the first floor landing - Master bedroom with large bay window to front. | second double bedroom to rear. | Bedroom three is a generous single bedroom currently utilised as a study. | Modern Family Bathroom/wc which has over bath shower and recessed vanity mirror with lighting | Two further good sized bedrooms. | Tiled shower room/wc | Externally - Block paved driveway to front providing off street parking and leading to a single garage. Lawned garden to front with borders. To the rear is a generous mature private garden laid to lawn with large paved patio and well stocked borders.

Services: Mains gas, electric, water and drainage | Tenure: Freehold | Council Tax: Band D | Energy Performance Certificate: D









Ground Floor

Approx. 68.9 sq. metres (741.5 sq. feet)

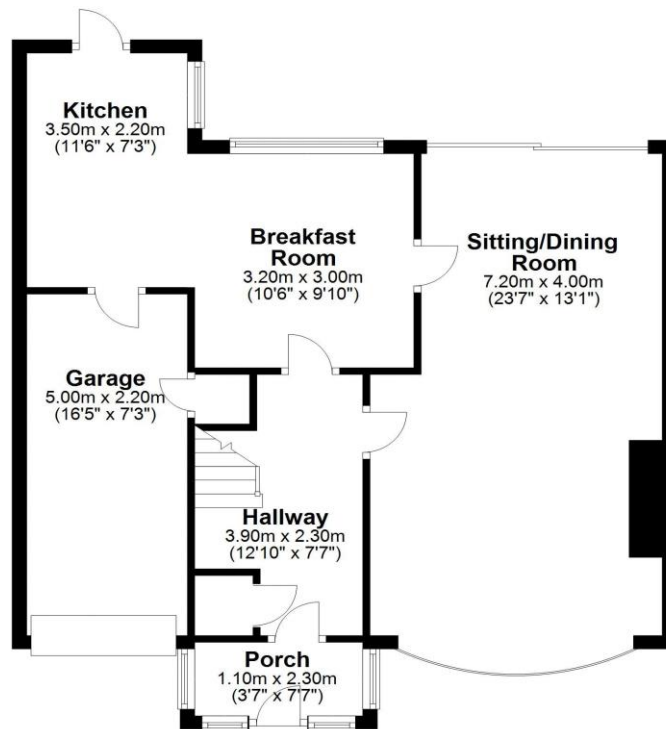

First Floor

Approx. 66.4 sq. metres (714.5 sq. feet)



Total area: approx. 135.3 sq. metres (1456.0 sq. feet)

33 Briardene Crescent, Gosforth

All enquiries to our Gosforth Office | 95 High Street, Gosforth, Newcastle upon Tyne NE3 4AA

T: 0191 213 0033 | www.sandersonyoung.co.uk

