



142 Main Street
North Sunderland, Seahouses





142 Main Street, North Sunderland, Seahouses, Northumberland, NE68 7UA

Guide Price £357,500

A substantial stone built house, located in the heart of the historic hamlet of North Sunderland, just a short distance from the thriving harbour town of Seahouses on Northumberland's Heritage Coastline. The deceptively spacious, four bedroom mid terrace home has been restored by the present owners over the last 20 years, creating a warm and welcoming home which would suit a variety of buyers including those seeking a large house for B&B accommodation, a main coastal home, a second holiday home or those seeking a commercial holiday let. The property has a fabulous private, enclosed rear garden with vegetable garden, greenhouse and various outbuildings, a covered secure passageway leading from the driveway to the garden, and driveway for two cars.

Impressive dining hallway with feature Inglenook style fireplace and stairs to the first floor | Generous sitting room, formerly a village shop, with dual aspect windows and a multi fuel stove | Lovely family kitchen/breakfast room with an extensive range of cabinets, and multi fuel stove | Utility room/rear lobby with ground floor WC | First floor | Superb master bedroom with ample space for free standing bedroom furniture | Three further double bedrooms | Nursery/store accessed from bedroom four | Well appointed family bathroom with freestanding roll top bath, twin wash hand basins and a separate shower | Externally - To the rear of the property is a large enclosed garden with feature patio area, pond/water feature, vegetable garden, greenhouse, timber shed and coal shed/log store | Solar hot water panel | Driveway to the front for two cars.

Services: Mains Electric, Water, Drainage & Oil Fired Central Heating | Tenure: Freehold | Council Tax: Band D | EPC: D









Ground Floor

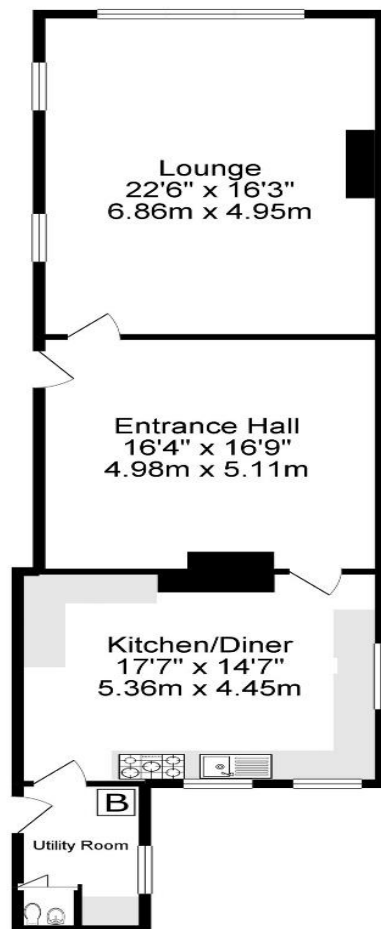

1st Floor

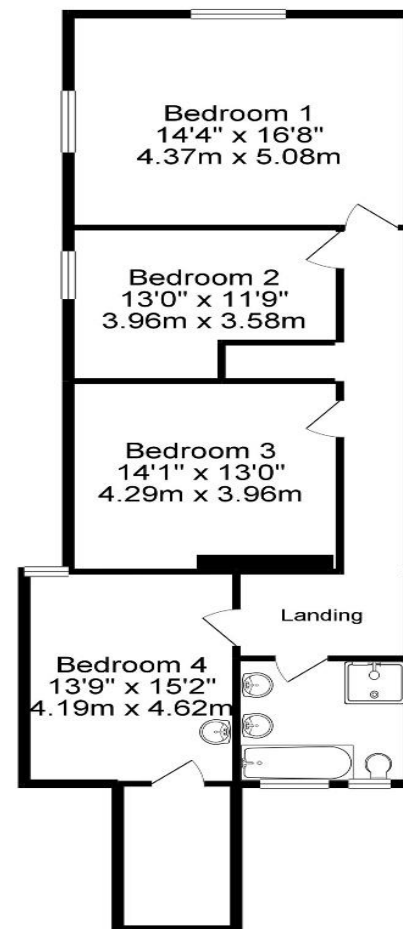

Whilst every attempt has been made to ensure the accuracy of the floorplan contained here, measurements of doors, windows, rooms and any other items are approximate and no responsibility is taken for any error, omission or mis-statement. This plan is for illustrative purposes only and should be used as such by any prospective purchaser. The services, systems and appliances shown have not been tested and no guarantee as to their operability or efficiency can be given.
Made with Metropix ©2019

All enquiries to our Alnwick Office | 35 Bondgate Without, Alnwick, Northumberland NE66 1PR

T: 01665 600 170 | www.sandersonyoung.co.uk

