



rare!

From Sanderson Young



Chesters Close
12 Adderstone Crescent, Jesmond



Chesters Close, 12 Adderstone Crescent, Jesmond, Newcastle Upon Tyne NE2 2HH

Guide Price £2,500,000

Following the very recent purchase of this stunning home in the heart of Jesmond, unforeseen circumstances have reluctantly led to the property being offered once more for sale. Chester's Close is arguably one of the most impressive houses available within the heart of Jesmond and provides an outstanding, three-storey, detached family home. Rare to the market and ideally situated on the prestigious Adderstone Crescent, the property was originally built in 1904 and boasts a wealth of period charm and character throughout. Externally, the formal entrance garden to Chesters Close is magnificent, with impressive box hedging and topiary, whilst the rear gardens are immaculately presented, with sunny terraces, a delightful summer house and established borders providing an array of colour throughout the seasons.

Ground Floor: Entrance Vestibule | Large Reception Hallway | Family Room | Study | Beautiful Drawing Room | Formal Dining Room | Kitchen/Breakfasting Room | Utility and Laundry Room | Second Kitchen Area | Stunning Orangery | First Floor: Master Bedroom Suite with Walk-In Luxury Bathroom/WC | Two Further Double Bedrooms, Both with En-Suite Bath/Shower Facilities | Second Floor: Two Further Bedrooms, One Currently Used as a Study | Games Room | Shower Room/WC | Large Attic and Storage Area | Externally: Large Double Driveway | Double Garage | Magnificent Entrance Garden | Immaculately Presented Rear Gardens with Superb Terraces, Summer House and Landscaped Borders

Services: Mains Gas, Electricity, Water and Drainage | Tenure: Freehold | EPC Rating: E

rare!
From Sanderson Young









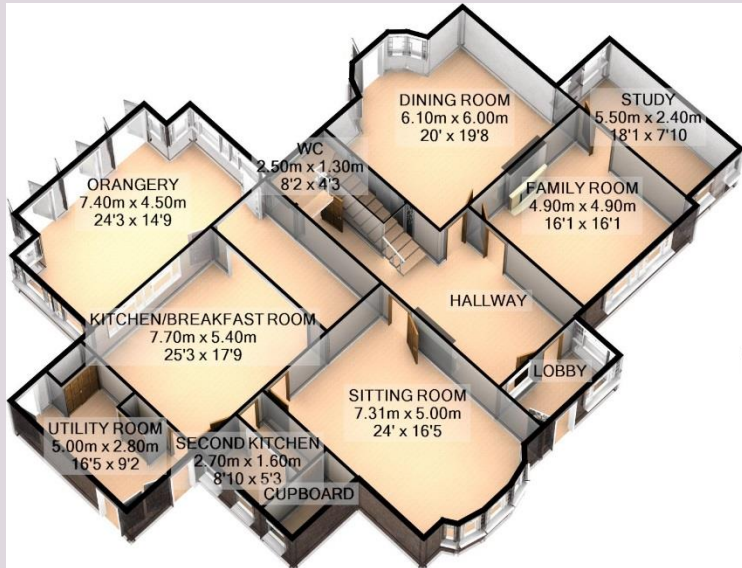

GROUND FLOOR
 APPROX. FLOOR
 AREA 236.5 SQ.M.
 (2545 SQ.FT.)

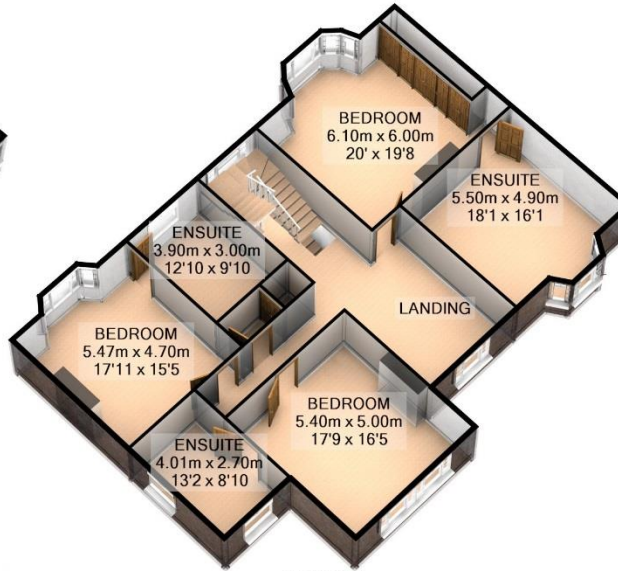

1ST FLOOR
 APPROX. FLOOR
 AREA 170.1 SQ.M.
 (1831 SQ.FT.)

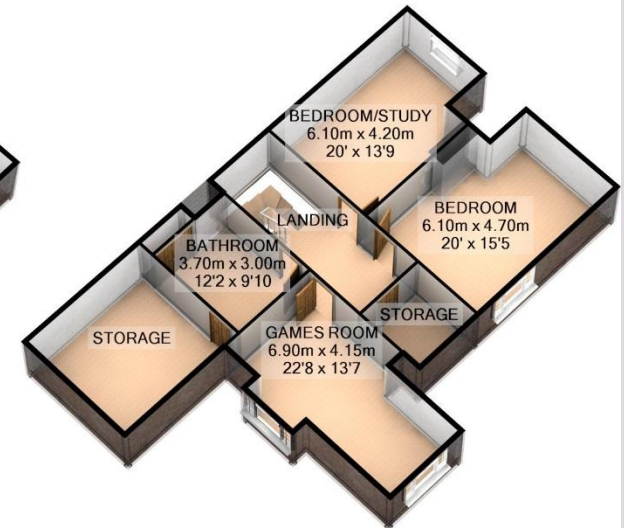

2ND FLOOR
 APPROX. FLOOR
 AREA 129.4 SQ.M.
 (1393 SQ.FT.)

TOTAL APPROX. FLOOR AREA 536.0 SQ.M. (5769 SQ.FT.)

For illustrative purposes only. Decorative finishes, fixtures, fittings and furnishings do not represent the current state of the property. Measurements are approximate. Not to scale
 Made with Metropix ©2017





rare!
From Sanderson Young



All confidential enquiries to:
rare! Office, The Old Bank, 30 High Street, Gosforth, Newcastle upon Tyne, NE3 1LX
E: duncan.young@sandersonyoung.co.uk | E: ashleigh.sundin@sandersonyoung.co.uk
T: 0191 2233500 | F: 0191 2233505 | www.sandersonyoung.co.uk